

TLV. Hook clamps

Steel or stainless steel



STANDARD EXECUTIONS

- **TLV.Z:** zinc-plated steel.
- **TLV.SST:** AISI 304 stainless steel.

SPECIAL EXECUTIONS ON REQUEST

Catch brackets in different shapes and finishes.

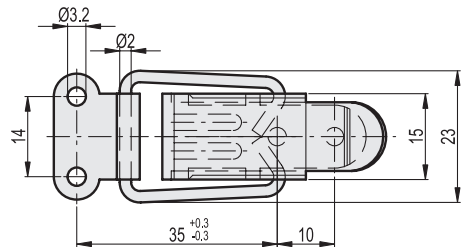
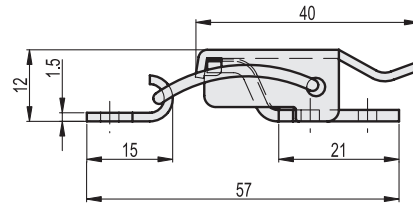

TLV.Z

METRIC

Code	Description	Max. working load [N]	Load at breakage [N]	⚖️
420243	TLV.Z-15/56+R	550	1000	23

TLV.SST

INOX STAINLESS STEEL METRIC

420242	TLV.SST-15/56+R	550	1000	23
--------	-----------------	-----	------	----



Latches

1223